

## PMF- 不锈钢内螺纹隔板直通

规格	A	B	b	C	D	E	F	L	G
PMF4-01	10	14	4.2	12	4	2	1/8"	31	M12*1
PMF4-02	10	17	4.2	12	4	2	1/4"	31	M12*1
PMF6-01	12	17	6.2	13	4	2	1/8"	31	M14*1
PMF6-02	12	17	6.2	13	4	2	1/4"	31	M14*1
PMF8-01	14	17	8.2	13	4	2	1/8"	31	M16*1
PMF8-02	14	17	8.2	12	4	2	1/4"	31	M16*1
PMF8-03	14	19	8.2	13	4	2	3/8"	31	M16*1
PMF8-04	14	24	8.2	15	4	2	1/2"	33	M16*1
PMF10-02	16	19	10.2	14	4	2	1/4"	35	M18*1
PMF10-03	16	19	10.2	15	4	2	3/8"	35	M18*1
PMF10-04	16	24	10.2	16	4	2	1/2"	36	M18*1
PMF12-02	18	22	12.2	14	4	2	1/4"	35	M20*1
PMF12-03	18	22	12.2	15	4	2	3/8"	35	M20*1
PMF12-04	18	22	12.2	16	4	2	1/2"	36	M20*1
PMF14-04	20	27	14.2	17	4	2	1/2"	37	M24*1
PMF16-04	22	27	16.2	18	4	2	1/2"	37	M24*1

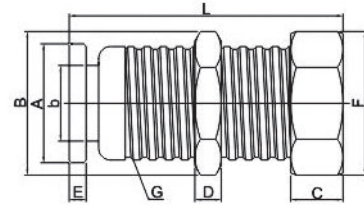

## PC- 不锈钢 G 螺纹直通

规格	A	B	C	D	d	L	I
PC6-G01	12	14	8	G1/8	6.2	19.5	5
PC6-G02	12	17	8	G1/4	6.2	21	6
PC8-G01	14	14	11	G1/8	8.2	23.5	5
PC8-G02	14	17	10	G1/4	8.2	23	6
PC8-G03	14	19	10	G3/8	8.2	23.5	6
PC8-G04	14	22	8	G1/2	8.2	24	8
PC10-G02	16	17	9	G1/4	10.2	22	6
PC10-G03	16	19	10	G3/8	10.2	23.5	6
PC10-G04	16	22	8	G1/2	10.2	23.5	9
PC12-G02	18	19	12	G1/4	12.2	25	6
PC12-G03	18	19	12	G3/8	12.2	25	6
PC12-G04	18	22	7	G1/2	12.2	23	9
PC14-G04	20	22	9	G1/2	14.2	25.5	9
PC16-G03	22	24	12	G3/8	16.2	25	6
PC16-G04	22	24	10	G1/2	16.2	27	9
PC4-M5	10	10	9	M5*0.8	4.2	20.5	4
PC4-M6	10	10	9	M6*0.8	4.2	20.5	4
PC4-M8	10	12	6	M8*1	4.2	18	5
PC6-M5	12	12	9	M5*0.8	6.2	20.3	4
PC6-M6	12	12	9	M6*0.8	6.2	20.3	4
PC6-M10	12	12	6	M10*1	6.2	18	5
PC8-M10	14	14	9	M10*1	8.2	21.4	5

